

**767 LT
REDUCER** (Cont'd)

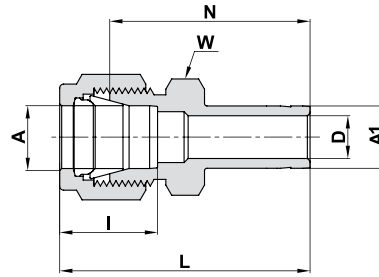

TUBE (INCH) TO STUB (METRIC)

Ordering Information	A Tube O.D.		A1 Tube O.D.	D		W Hex. Flat	N		L		I	
	inch	mm	mm	inch	mm	inch	inch	mm	inch	mm	inch	mm
767LT _ 1/8 X 6	1/8	3.17	6	.09	2.30	7/16	1.16	29.46	1.42	36.06	.50	12.7
767LT _ 1/4 X 6	1/4	6.35	6	.16	4.00	1/2	1.25	31.75	1.54	39.11	.60	15.2
767LT _ 3/8 X 8	3/8	9.52	8	.22	5.60	5/8	1.42	36.06	1.71	43.43	.66	16.8
767LT _ 3/8 X 12	3/8	9.52	12	.28	7.11	5/8	1.62	41.15	1.91	48.51	.66	16.8

**767 LM
REDUCING PORT
CONNECTOR**

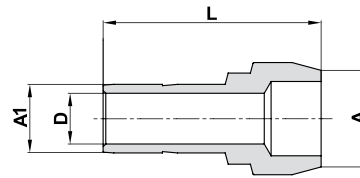

CONNECTS TWO LET-LOK® PORTS (METRIC)

Ordering Information	A Tube O.D.		A1 Tube O.D.	D	L
	mm	mm	mm	mm	mm
767LM _ 6 X 3	6	3	2.1	22.9	
767LM _ 8 X 6	8	6	4.0	24.7	
767LM _ 10 X 6	10	6	4.0	25.8	
767LM _ 10 X 8	10	8	5.6	26.1	
767LM _ 12 X 6	12	6	4.0	29.1	
767LM _ 12 X 8	12	8	5.6	29.8	
767LM _ 12 X 10	12	10	7.1	30.6	
767LM _ 16 X 12	16	12	8.8	37.5	
767LM _ 38 X 25	*38	25	19.8	65.8	

CONNECTS TWO LET-LOK® PORTS (INCH)

Ordering Information	A Tube O.D.		A1 Tube O.D.		D		L	
	inch	mm	inch	mm	inch	mm	inch	mm
767LM _ 1/8 X 1/16	1/8	3.17	1/16	1.58	.03	0.75	.68	17.3
767LM _ 1/4 X 1/16	1/4	6.35	1/16	1.58	.03	0.75	.71	18.0
767LM _ 1/4 X 1/8	1/4	6.35	1/8	3.17	.08	2.03	.89	22.6
767LM _ 3/8 X 1/8	3/8	9.52	1/8	3.17	.08	2.03	.91	23.2
767LM _ 3/8 X 1/4	3/8	9.52	1/4	6.35	.17	4.20	.98	24.9
767LM _ 1/2 X 1/4	1/2	12.70	1/4	6.35	.17	4.20	1.15	29.2
767LM _ 1/2 X 3/8	1/2	12.70	3/8	9.52	.28	7.10	1.20	30.5
767LM _ 3/4 X 1/2	3/4	19.05	1/2	12.70	.39	9.90	1.49	37.9

ASSEMBLY INSTRUCTIONS
Reducer Port Connector 767 LM

Tighten the nut.
1-1/4 turns of the nut are required for 1/4" (6 mm) and higher.
A 3/4 turn of the nut is required for 3/16" (4 mm) and lower.

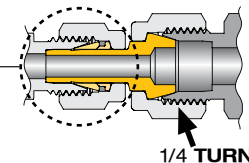

* Including low friction paste, see page 91
"D" - Dimension is minimum opening.
Dimensions are for reference only, and are subject to change without notice.